

SmartBridge™ PoE

Advanced Lighting Controller with BACnet, Web Services and PoE

SmartBridge™ PoE offers a very compact and cost-effective solution to a wide range of DALI lighting applications, implementing standard software objects for all commonly used lighting control functions.

SmartBridge™ PoE provides a single channel of DALI lighting control. The unit incorporates a DALI bus power supply capable of supplying 230mA, under full software control.

Network communication is provided by a 10/100bT Ethernet port, offering a full BACnet /IP interface with the available data from every DALI device available via standard BACnet data objects.

The unit also incorporates Power over Ethernet (PoE) technology for simplified installation and minimised wiring requirements.

A powerful 32-bit ARM processor provides Scene Control, Constant Light Control plus Occupancy-based control (presence or absence) for up to 16 zones of lighting. SmartBridge™ PoE can be used in conjunction with SmartSensor™ lighting sensors and DALI scene plates or third-party DALI 2 sensors or button modules to complete the solution.

SmartBridge™ PoE features full support for DALI Emergency fittings as well as exposing all the DALI channel, group and lamp feedback via the Ethernet interface.

Two pushbuttons and two LEDs on the front panel provide simple visual user feedback as well as a manual override facility. In addition, they allow an installer to complete post-installation tests without the use of external tools.

Setup, commissioning and maintenance of the unit is provided via a simple, intuitive Web interface via a PC, smartphone or tablet.



SmartBridge™ PoE

Benefits

- Very compact form factor
- Power over Ethernet for simplified installation
- Built-in bus power supply with full control and monitoring of bus power status
- Panel mount or localised installation
- Web-based setup and commissioning using PC, tablet or phone via intuitive workflow
- Simple, rapid backup and restore via web interface
- Self-healing bus to simplify maintenance
- Full Support for Emergency Lighting Test and Reporting
- Full BACnet interface for all DALI data points
- Fault and Alarm notification via BACnet notification class
- IoT functionality via MQTT
- Designed and manufactured in the UK

Connections

DALI:

Number: 1 x DALI channel

Isolation: 4 kV

Collision Detection: Active collision detection with data recovery

DALI bus power: Integral DALI bus power supply with full software control

Max. Current: 230mA

Ethernet:

Physical: Ethernet 10/100baseT

Speed: 10/100Mbit/s

Supported protocols: BACnet IP, HTML5 / Javascript, MQTT

Data Storage:

Type: Serial EEPROM

Capacity: 1GB

User Interface:

Status: 2 x tri-Colour LED (Device status + Channel Status)

Local Control: 2 x Push Button (Setup + Override Hand/Off/Auto)

Technical Specifications

Supply Voltage: 48V Power over Ethernet (IEEE 802.3af / 802.3at Type 1)

Power Consumption: <7W (fully loaded DALI channel), <1W (standby)

Enclosure Material: Moulded thermoplastic, non-flammable to UL94 V0

Dimensions: 22.5mm W x 80mm D x 100mm H (incl)

Weight: 95g (controller only without connectors).

Operating Temperature: 0 to 45 °C

Conforms to: EN 62386-101:2014+A1:2018, EN 62386-103:2014+A1:2018
EN 55032:2015, EN 55035:2017
IEC 62368-1:2014 (Second Edition)
BS EN 61347-1-2008-A2-2013 (Isolation)

Ordering

SmartBridge™ PoE order code 442000U
1 x DALI, 1 x Ethernet PoE

Wall mounting clip order code 442095B
side- or end-on mounting, zinc-coated steel

PoE Power Injector order code 4420PIN
230V AC in, IEEE 802.3af

Calon Associates Limited

2 Whitworth Court
Runcorn WA7 1WA, UK

T +44 1925 320 320
E sales@caloncontrols.com

Calon Europe Limited

Lucan, Co. Dublin
K78 WP57, IRL

T +353 1 902 6710
E sales@caloncontrols.com

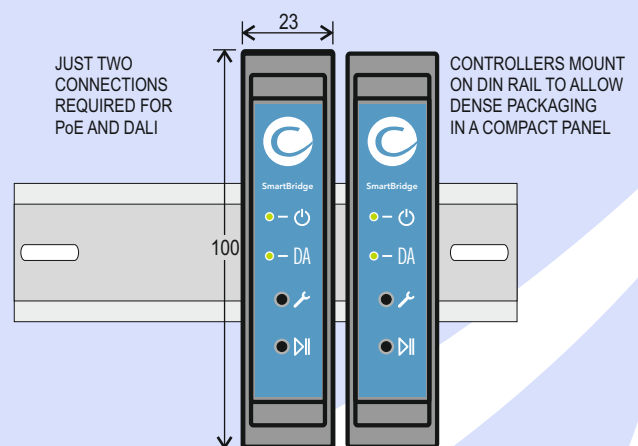
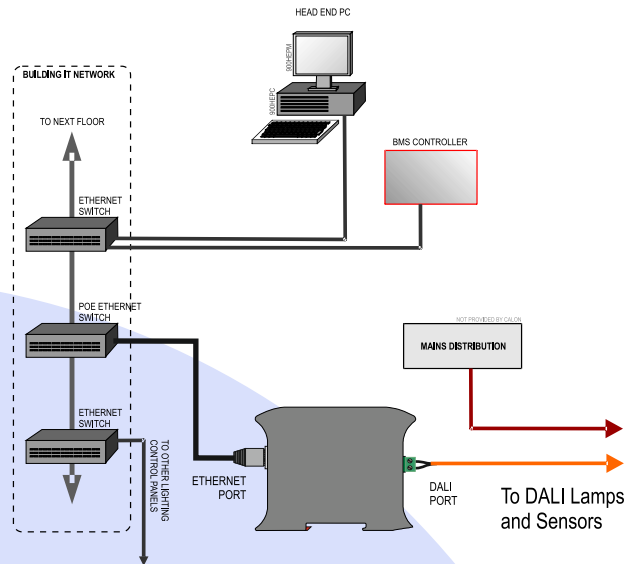

ACCESSIBLE CONTROLS FOR ENGINEER
HAND / OFF / AUTO, SETUP & RESET
INDICATORS FOR POWER, STATUS, DALI COMMS

